

Lochgilphead Front Green

MEET THE CONTRACTOR

WEDNESDAY 16TH JUNE 2021

7PM



Agenda

- ▶ Welcome and Introductions
- ▶ The Front Green Project
- ▶ Hawthorn Heights
- ▶ Questions and Answers



The Front Green Project

- overview of the consultation & design process
- timing / timescales for construction work



STAKEHOLDER ENGAGEMENT

We visited Lochgilphead in January and spoke to 23 businesses and 5 residents whose properties are adjacent to the Front Green and Colchester Square.

50%

Nearly 50% of people said they thought the new developments needed 'wow factor' to encourage visitors to stop and stay.

85%

Over 85% of people said they would like to see more events and activities on the Front Green.

The word cloud opposite captures what the people we spoke to would like to see on the Front Green and in Colchester Square.



PROJECT AMBITIONS

Bring activity and events back to the front green.

Create a reason for visitors to stop and spend time in Lochgilphead.

Create a great public space / park for the local community and visitors.



LOCHGILPHEAD

FRONT GREEN

Come and
have
your say!

How can we improve the Front Green and Colchester Square?

Come and find us on the corner of Colchester Square
and Poltalloch Street for a chat and a cuppa.

Saturday 9th March
11am - 4pm

See initial design options
for the Front Green &
Colchester Square and
tell us what you think.

Saturday 13th April
11am - 4pm

Come and see the
developing designs &
help to shape them.

Check our progress at:
argyll-bute.gov.uk/frontgreen

Or contact Nick Wright on:
thefrontgreen@gmail.com



LOCHGILPHEAD FRONT GREEN

Public Consultation 9th March 2019

Feedback and Findings





HEADLINE FIGURES



people of all ages, from
Lochgilphead and the
surrounding communities,
attended the event

202

comments left by the
public on the day

506

votes cast on the nine
'Project Ideas' on the day

128

ideas from students at
Lochgilphead High School

175

responses left on the online
survey and counting...



PROJECT IDEA VOTING

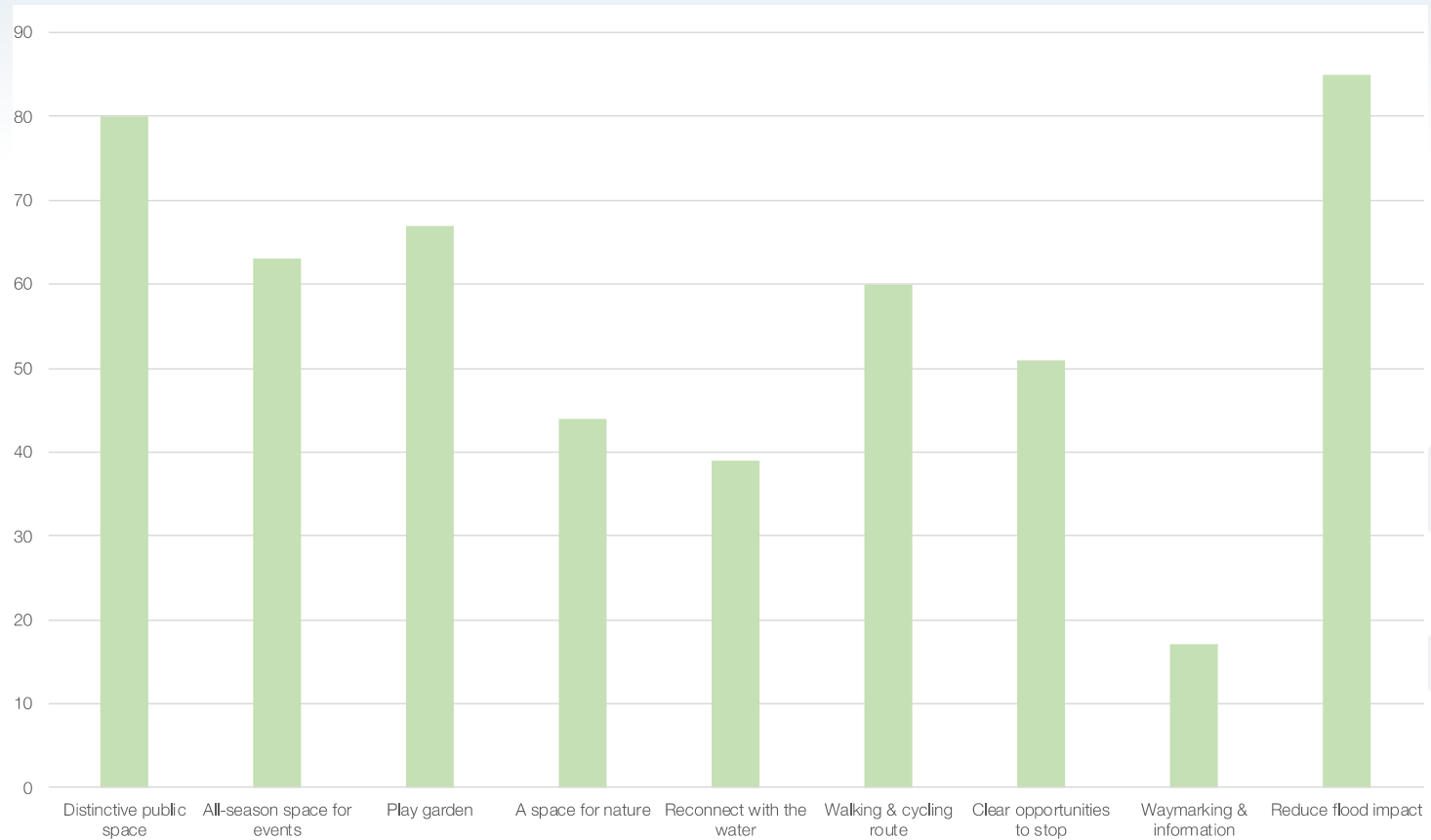

HEADLINE FIGURES

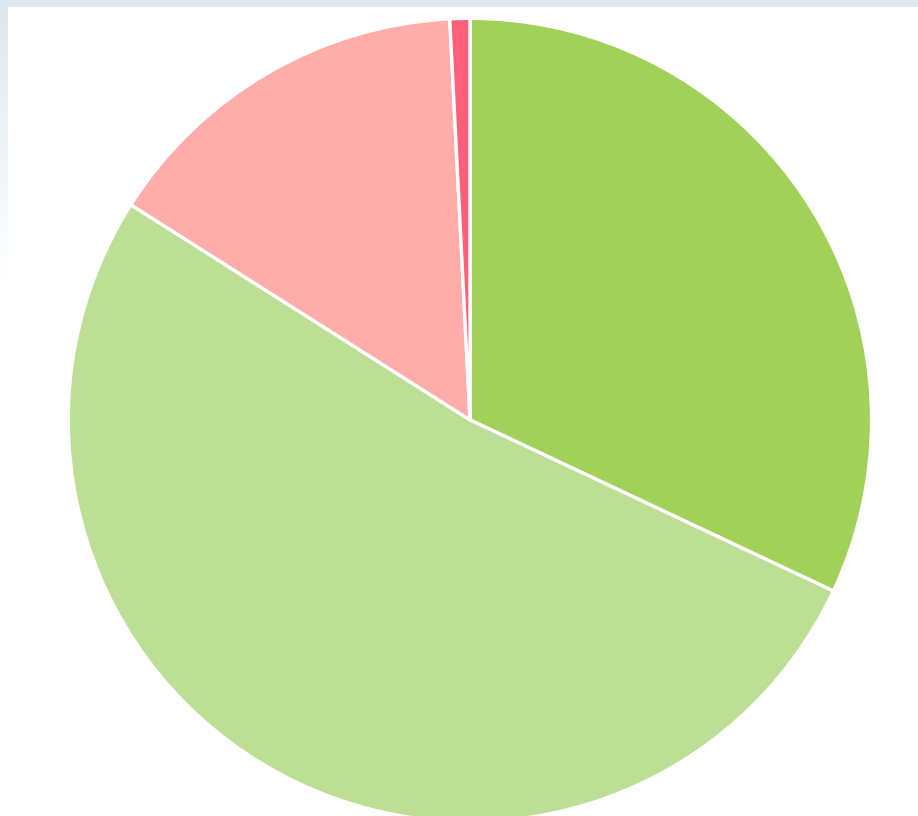

Overall statement of support for proposals



Statement of support for specific element(s) of the proposals



Negative comments regarding specific element(s) of the proposals



Overall negative statement objecting to the proposals



WHAT ELEMENTS DO YOU LIKE THE MOST?

All nine design elements were equally well received, with between 28 - 35 sticker 'votes' cast for each element.

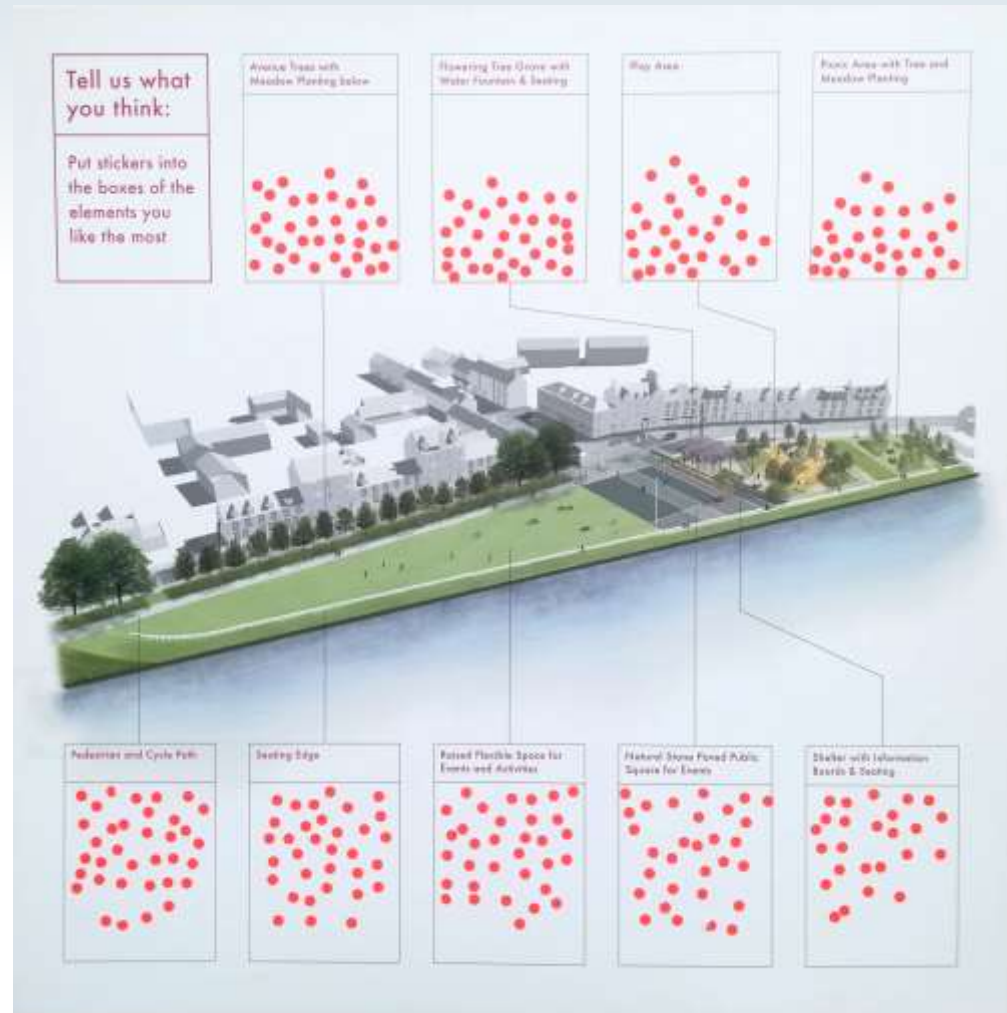

early 2021

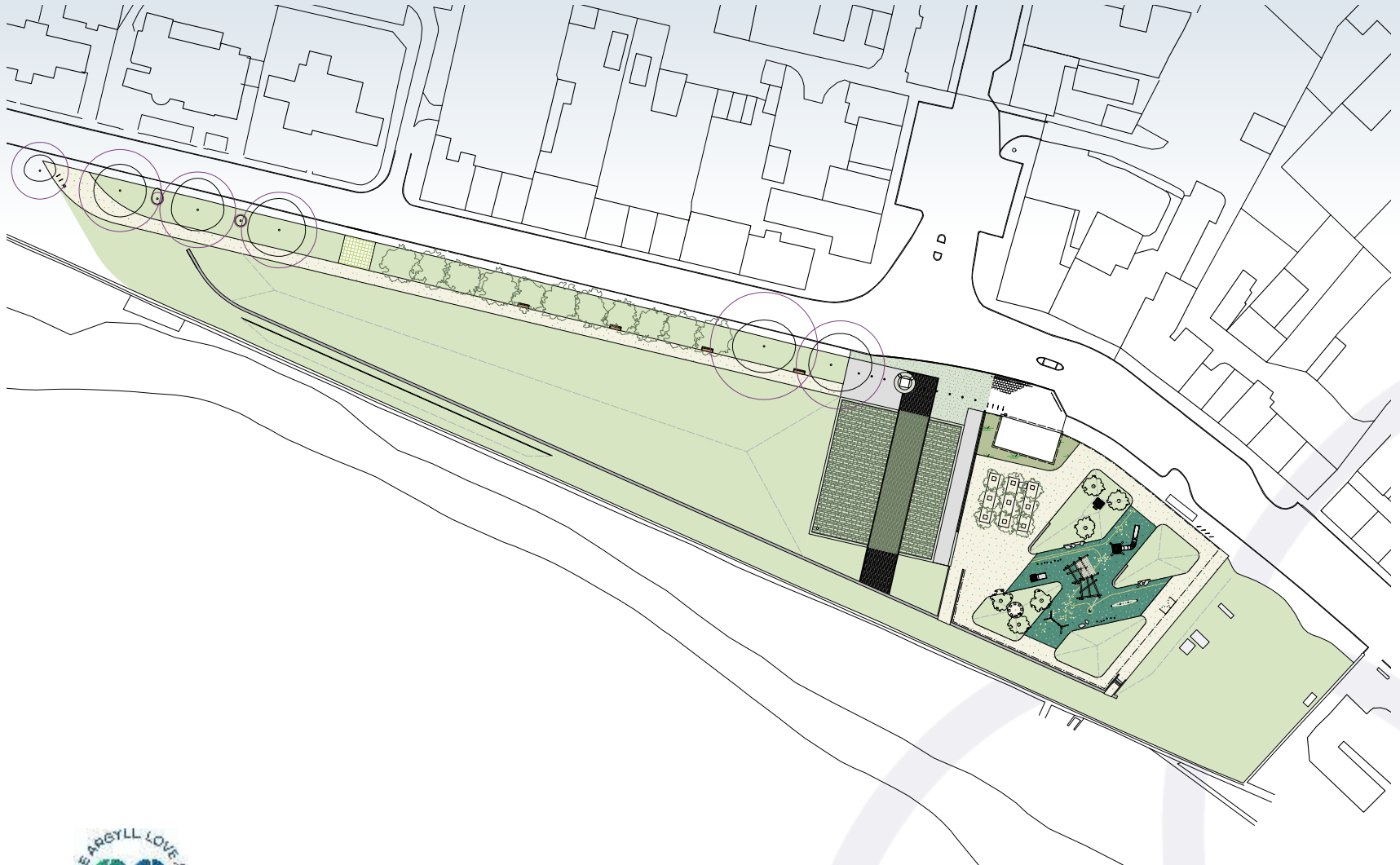

Bute • Helensburgh • Islay • Oban • Mull • Campbeltown • Iona • Dunoon • Tiree • Lochgilhead • Seil ...

#abplace2b



Hawthorn Heights



HAWTHORN HEIGHTS - HISTORY

- 1999 - Established as a Landscaping Contractor working on Small Private and Public works in NI & ROI
- Family run business with a history in farming and landscaping
- 2007 - Limited Company in 2007
- 2007 - Expanded into Playground market
- 2010 - Expanded into Artificial Sports Pitches market
- 2016 - Expanded into Scottish Market
- 2018 - Moved to purpose built headquarters



ACCREDITATIONS



ISO 9001
ISO 14001

Portée disponible sur
socotec-certification.com



Association
of Landscape
Contractors
of Ireland



Part of Capita plc





Hermitage Park, Helensburgh



ZETLAND PARK, GRANGEMOUTH



MAIN GOAL – HEALTH & SAFETY

We want to ensure the safety of the local public, visitors & our personnel on site at all times

- The entire Front Green will remain close to the public for the duration of the works. We have erected Construction signage on site at access and egress points to warn the passing public of our construction areas.
- We have ensured that all existing pedestrian pathways along Poltalloch Street and Lochnell Street remain open during the first phase of the works. As the works progressed, a section of this pathway will be closed for a short period of time. Signage will be erected to both advise and divert pedestrians accordingly.
- We have provided emergency contact numbers along our fence lines in the event of an emergency



RELATIONSHIP WITH THE LOCAL COMMUNITY

- Continuous liaisons with the community throughout the contract
- Protection of the public is paramount
- If you, as a community, notice anything untoward or any issues of vandalism or anti-social behaviour please contact us on **02871814816 / 07801105642.**
- Our team on the ground are approachable & our emergency contact details are detailed on our signage



CO-OPERATION OF THE COMMUNITY

- Co-operation & understanding during construction would be appreciated
- We will erect appropriate signage to let visitors know when a section of the A83 pathway will be closed & will provide an estimated timeframe for the closure
- We will post regular project updates and progress images on our Facebook page, which will keep everyone informed and provide a story book of project progress



STAFF ON SITE

We have dedicated our most senior and experienced personnel to the Lochgilphead Front Green Regeneration Project to guarantee a high quality finish. Site personnel consists of:

- **Site Foreman** – responsible for contract on the ground
- **First Aider** – in the event of an emergency
- **Skilled Site Construction Division** – for all intricate ground works, paving, landscaping, furniture installations, pathways etc.
- **Plant operatives** – essential for the movement of materials & excavation works



HIGH QUALITY FINISH

We pride ourselves on our build **QUALITY** and are confident that the Lochgilphead Front Green Regeneration Project will enable us to showcase our **HIGH QUALITY** workmanship – the community will not be disappointed.

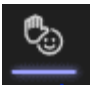

Questions and answers

Please use  or type Q in the chat box to alert the team that you would like to ask a question.



Thank you for your time

Please visit www.argyll-bute.gov.uk/frontgreen for further information about the project or to view these slides again

